

SHARP®



SADDLE STITCH FINISHER

OPERATION MANUAL

	Page
• SADDLE STITCH FINISHER	1
• PARTS OF THE SADDLE STITCH FINISHER	1
• SPECIFICATIONS	2
• FUNCTIONS OF THE SADDLE STITCH FINISHER	3
• USING THE SADDLE STITCH FINISHER FUNCTIONS	5
• USING THE SADDLE STITCH FINISHER TO MAKE COPIES	6
• REPLACING THE STAPLE CARTRIDGE AND REMOVING STAPLE JAMS	8
• REMOVING PAPER MISFEEDS	11
• TROUBLESHOOTING	14
• USING THE KEY OPERATOR PROGRAMS	15

For users in the USA

This device complies with Part 15 of the FCC rules. Operation is subject to the following two conditions: (1) This device may not cause harmful interference, and (2) this device must accept any interference received, including interference that may cause undesired operation.

WARNING:

FCC Regulations state that any unauthorized changes or modifications to this equipment not expressly approved by the manufacturer could void the user's authority to operate this equipment.

Note:

This equipment has been tested and found to comply with the limits for a Class A digital device, pursuant to part 15 of the FCC Rules. These limits are designed to provide reasonable protection against harmful interference when the equipment is operated in a commercial environment. This equipment generates, uses, and can radiate radio frequency energy and, if not installed and used in accordance with the operation manual, may cause harmful interference to radio communications. Operation of this equipment in a residential area is likely to cause harmful interference in which case the user will be required to correct the interference at his own expense.

Warning

This is a Class A product. In a domestic environment this product may cause radio interference in which case the user may be required to take adequate measures.

This equipment complies with the requirements of Directive 89/336/EEC as amended by 93/68/EEC.

Dieses Gerät entspricht den Anforderungen der EG-Richtlinie 89/336/EWG mit Änderung 93/68/EWG.

Ce matériel répond aux exigences contenues dans la directive 89/336/CEE modifiée par la directive 93/68/CEE.

Dit apparaat voldoet aan de eisen van de richtlijn 89/336/EEG, gewijzigd door 93/68/EEG.

Dette udstyr overholder kravene i direktiv nr. 89/336/EEC med tillæg nr. 93/68/EEC.

Quest'apparecchio è conforme ai requisiti della direttiva 89/336/EEC come emendata dalla direttiva 93/68/EEC.

Η εγκατάσταση αυτή ανταποκρίνεται στις απαιτήσεις των οδηγιών της Ευρωπαϊκής Ένωσης 89/336/ΕΟΚ, όπως ο κανονισμός αυτός συμπληρώθηκε από την οδηγία 93/68/ΕΟΚ.

Este equipamento obedece às exigências da directiva 89/336/CEE na sua versão corrigida pela directiva 93/68/CEE.

Este aparato satisface las exigencias de la Directiva 89/336/CEE, modificada por medio de la 93/68/CEE.

Denna utrustning uppfyller kraven enligt riktlinjen 89/336/EEC så som kompletteras av 93/68/EEC.

Dette produktet oppfyller betingelsene i direktivet 89/336/EEC i endringen 93/68/EEC.

Tämä laite täyttää direktiivin 89/336/EEC vaatimukset, jota on muutettu direktiivillä 93/68/EEC.



The CE mark logo label is affixed on an equipment in case that the directives described in the above sentence are applicable to the product. (This sentence is not applicable in any country where the above directives are not required.)

SADDLE STITCH FINISHER

The saddle stitch finisher features the offset function, which makes it easy to distinguish sets of output, and the saddle stitch (pamphlet) function, which automatically staples and folds output down the center. An optional punch unit can also be installed to punch holes in output.

PARTS OF THE SADDLE STITCH FINISHER

Staple section

Open the front cover and pull out this section to replace the staple cartridge or remove a staple jam.

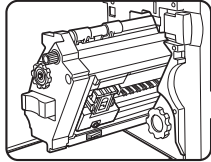

Stapler compiler

Paper to be stapled is temporarily stacked here.

Offset tray

This tray is used for the offset function and the staple function.

Saddle stitch tray

Saddle stitch (Pamphlet) output is delivered to this tray.

Front cover

Open this cover to replace the staple cartridge or remove a staple jam.

Top cover

Open this cover to remove a paper misfeed.

Center cover

Paper moves through here when output to the saddle stitch finisher.

Detach button

Press this button when a paper misfeed or other problem occurs to detach the saddle stitch finisher from the machine.

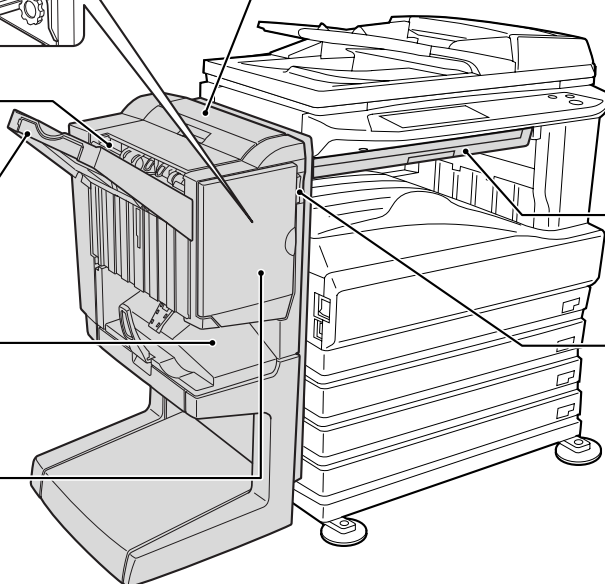

⚠ Caution

- Do not press down on or place heavy objects on the saddle stitch finisher (or on its trays in particular).
- During output to the offset tray, the offset tray may move up and down.

Display screens, messages, and key names shown in this manual may differ from the actual screens, messages, and key names due to modifications made for improvement.

This operation manual is described based on the American spelling standard.

SPECIFICATIONS

Name	Saddle Stitch Finisher
Number of trays	2
Paper output	Face down (when using the offset tray)
Tray types	Upper tray: Offset tray Lower tray: Saddle stitch tray
Tray capacity	Upper tray: Without stapling 8-1/2" x 11" / A4 size or less (21 lbs.(80 g/m ²)): 1000 sheets maximum 8-1/2" x 13" / B4 size or greater (21 lbs.(80 g/m ²)): 500 sheets maximum Stapling 8-1/2" x 11" / A4 size or less (21 lbs. (80 g/m ²)): 30 sets and 1000 sheets maximum 8-1/2" x 13" / B4 size or greater (21 lbs. (80 g/m ²)): 30 sets and 500 sheets maximum Lower tray (saddle stitch): Number of pages that can be stapled → 10 sets x 6-10 pages per set, or 20 sets x 1-5 pages per set
Paper size	Upper tray: 11" x 17", 8-1/2" x 14", 8-1/2" x 13", 8-1/2" x 11", 8-1/2" x 11"R, 5-1/2" x 8-1/2", A3, B4, A4, A4R, B5, B5R, A5 Lower tray (saddle stitch): 11" x 17", 8-1/2" x 11"R, A3, B4, A4R
Paper weight	Upper tray: 16 lbs. to 54 lbs. (60 g/m ² to 200 g/m ²) Lower tray (saddle stitch): 16 lbs. to 28lbs. (60 g/m ² to 105 g/m ²)
Paper type	Upper tray: plain paper, heavy paper, letterhead paper, recycled paper, color paper Lower tray (saddle stitch): plain paper, letterhead paper, recycled paper, color paper
Paper full detection	Upper tray / lower tray (saddle stitch): Yes
Offset function	Upper tray only
Allowed paper sizes for stapling	Upper tray: 11" x 17", 8-1/2" x 14", 8-1/2" x 13", 8-1/2" x 11", 8-1/2" x 11"R, A3, B4, A4, A4R, B5, B5R Lower tray (saddle stitch): 11" x 17", 8-1/2" x 11"R, A3, B4, A4R
Number of pages that can be stapled	8-1/2" x 11", A4 or smaller: 50 pages (21 lbs. (80 g/m ²)) 8-1/2" x 13", B4 or greater: 25 pages (21 lbs. (80 g/m ²))
Stapling positions	Upper tray: 3 positions (top left staple, two left staples, lower left staple) Lower tray (saddle stitch): 4-23/32"(120 mm) pitch from center of paper
Paper feeding	Center reference
Power supply	From power unit of multifunction machine
Dimensions	28-1/32" (W) x 23-3/4" (D) x 40-3/64" (H)(712 mm (W) x 603 mm (D) x 1017 mm (H)) (two trays or four trays installed) 28-1/32" (W) x 23-3/4" (D) x 36-7/64" (H)(712 mm (W) x 603 mm (D) x 917 mm (H)) (three trays installed)
Weight	Approx. 101.4 lbs. (46 kg)(finisher: 86 lbs. (39 kg), joint: 15.4 lbs. (7 kg))

Name	Punch module			
Model*1	AR-PN1A	AR-PN1B*2	AR-PN1C*3	AR-PN1D*3
Number of holes	2	3 or 2	4	4
Paper sizes for hole punching	11" x 17", 8-1/2" x 14", 8-1/2" x 13", 8-1/2" x 11", 8-1/2" x 11"R, A3, B4, A4, A4R, B5, B5R	3 holes: 11" x 17", 8-1/2" x 11", A3, A4 2 holes: 8-1/2"x14", 8-1/2" x 13", 8-1/2" x 11"R	A3, A4	11" x 17", 8-1/2" x 14", 8-1/2" x 13", 8-1/2" x 11", 8-1/2" x 11"R, A3, B4, A4, A4R, B5, B5R

*1 Multiple punch modules cannot be installed together. Some models may not be available in some regions.

*2 With AR-PN1B, two or three holes can be punched depending on the paper size.

*3 With AR-PN1C and AR-PN1D, the number of holes is the same. The hole interval, however, is not the same.

Diagrams and contents are subject to change without notice.

Supplies

The following staple cartridge is required as a supply for the saddle stitch finisher:

- AR-SC2
Staple Cartridge (approx. 5000 staples x 3)

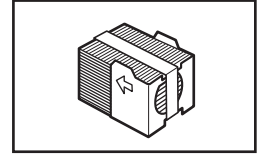

FUNCTIONS OF THE SADDLE STITCH FINISHER

■ Sort function

Collates printed pages

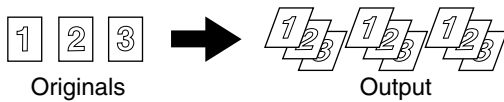

■ Group function

Groups printed pages by page

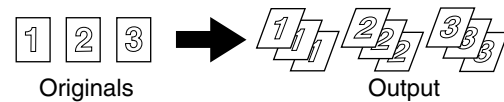

■ Offset function

Offset function "ON"

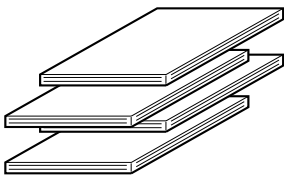

Offset function "OFF"

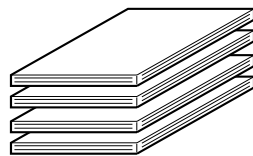

The offset function offsets each set of output from the previous set for easy separation. (On the saddle stitch finisher, the offset function is only possible using the offset tray.)

The offset function does not operate when the staple sort function is selected.

■ Staple sort function

Each set of output is collated by the sort function, stapled, and delivered to the upper (offset) tray. Three stapling positions are available: top left staple, two left staples, or lower left staple.

■ Saddle stitch (Pamphlet stapling) function

Each set of output is stapled in two places along the centerline of the paper, folded (with the side facing up inside), and delivered to the lower (saddle stitch) tray. In the factory default settings, the saddle stitch finisher is set to staple and fold sets after "Pamphlet copy" is performed. If desired, the "Pamphlet copy" function can be disabled using the key operator programs.

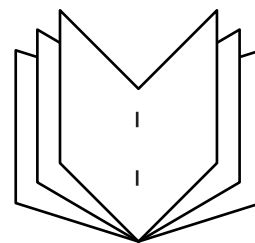

"Pamphlet copy" is used to copy two originals onto the front side and two originals onto the back side of each sheet of paper for easy creation of a pamphlet (See the operation manual for copier).

■ Punch function (only when a punch unit is installed)

When an optional punch unit is installed on the saddle stitch finisher, holes can be punched in the output. Punched output is delivered to the offset tray.

The punch function cannot be used in combination with the saddle stitch (pamphlet stapling) function. For paper sizes that can be punched, see the specifications on page 2.

[Example]

Original 1

Punch hole positions

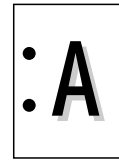
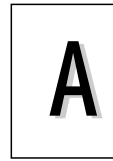

Original 2

Punch hole positions



⚠ Caution

- The following types of paper cannot be stapled:
Transparency film, heavy paper, label sheets, envelopes, postcards, thin paper
- The following types of paper cannot be punched:
Transparency film, label sheets, envelopes, postcards, thin paper
- Be sure to select the same paper size for the output. Stapling and punching are not possible when different sizes are mixed together. Note, however, that if the widths are the same, the "mix size original feeding mode"* function can be used to staple and punch different sizes of paper (saddle stitch is not possible).
* Stapling and punching are not possible if "mix size original feeding mode" includes sizes that cannot be stapled (such as 5-1/2" x 8-1/2" and A5).

USING THE SADDLE STITCH FINISHER FUNCTIONS

■ Using the saddle stitch finisher functions in copy mode

Touch the [OUTPUT] key in the main screen of copy mode to display the screen for selecting saddle stitch finisher functions. Selections include the sort function, staple sort function, saddle stitch function, group function, and output tray.

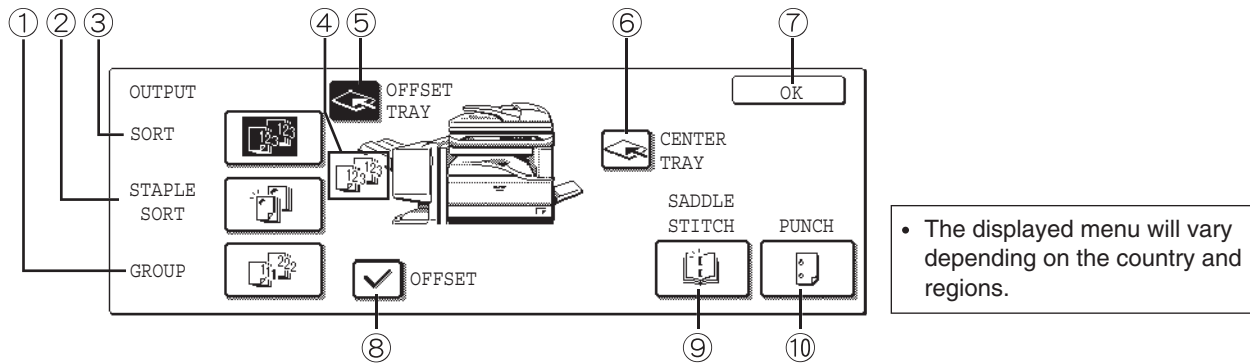

- ① **[GROUP] key (p.3)**
Select this function to have output grouped by page.
- ② **[STAPLE SORT] key (p.3)**
Select this function to have output collated into sets and stapled. The output is delivered to the offset tray (without being offset).
- ③ **[SORT] key (p.3)**
Select this function to have output collated into sets.
- ④ **Icon display**
When the sort, staple sort, group, or saddle stitch function is selected, the corresponding icon appears here.
- ⑤ **[OFFSET TRAY] key (p.1)**
Select this key to have output delivered to the offset tray. (When the staple sort function is selected, the offset tray is automatically selected.)
- ⑥ **[CENTER TRAY] key**
Select this key to have output delivered to the center tray.
- ⑦ **[OK] key**
Touch this key to close the screen and return to the main screen.
- ⑧ **[OFFSET] key (p.3)**
When a checkmark appears, the offset function operates. When the checkmark is removed, the offset function does not operate. (The offset function does not operate when the staple sort function or the saddle stitch function is selected.)
- ⑨ **[SADDLE STITCH] key (p.3)**
Each set of output is stapled along the centerline of the paper and folded.
When this function is selected, the pamphlet copy function (page 45 of operation manual for copier) is automatically selected.
- ⑩ **[PUNCH] key (p.4)**
When a punch unit is installed, select this key to punch holes in the output.

Note When "AUTOMATIC SADDLE STITCH" is disabled in the key operator programs, the "PAMPHLET COPY" is automatically deselected (p.15).

* When a function is selected, it is highlighted.

Caution When the saddle stitch finisher is disabled in the key operator programs, the saddle stitch finisher functions cannot be used (p.15).

■ Using the saddle stitch finisher functions in printer mode

To use the staple function in printer mode, select "Properties" in the Print window. In the "Finishing" field of the "Main" tab, select "Left", "Right", or "Top" for "Binding Edge", and "1 Staple" or "2 Staples" for "Staple".

To use the pamphlet function, select the "Pamphlet Style" radio button in the "Document Style" field and then select "Actual size" or "2-UP". In the "Finishing" field, select "2 Staples" for "Staple".

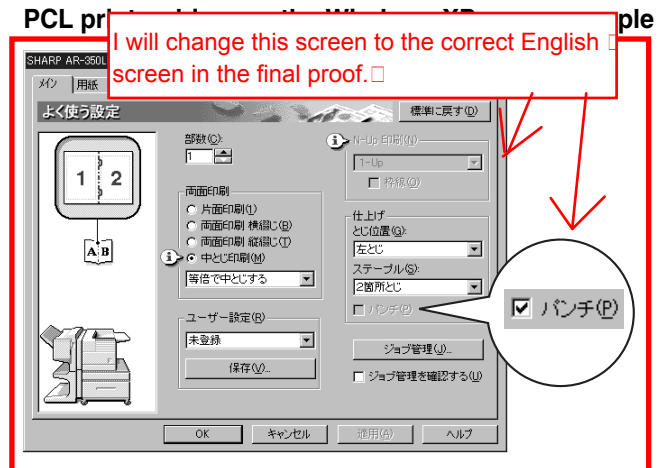

Caution Some printers do not have the pamphlet printing function.

Using the punch function when an optional punch unit is installed

To use the punch function, select the "Punch" checkbox in the "Finishing" field of the "Main" tab shown above.



- To use the above printer function, the peripheral device installation settings must be correctly configured in the printer driver properties. To configure the peripheral device installation settings, right-click the icon of the installed printer driver, select "Properties", and then select the "Options" tab.
- The paper selection and combination of functions already selected may prevent some settings from being selected. For detailed explanations of the settings, see the Help file for the printer driver.

USING THE SADDLE STITCH FINISHER TO MAKE COPIES

■ Orientation of the original when using the saddle stitch finisher function

When using the saddle stitch finisher to staple, make pamphlets, or punch holes, place the original as shown below. Staple and punch positions vary depending on the staple position setting and the orientation of the original.

Using the RSPF

Place the original face up.

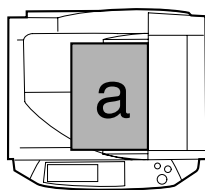

Using the document glass

Place the original face down.

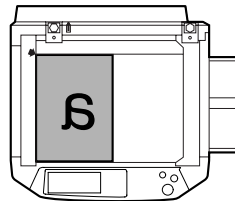

Staple positions (example)

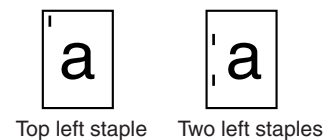

(11" x 17" and 8-1/2" x 14" (A3 and B4) size portrait originals)

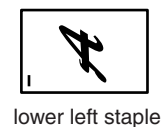
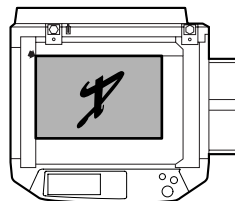
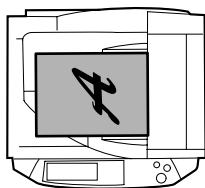

- When loading letterhead paper in the tray, orient the paper so that the letterhead is away from you or to the left, as shown at right.
- When the staple sort or punch function is used, the automatic original image rotation function does not operate.

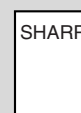

The procedure for using the staple sort function is explained below.

1 Place the original (p.6).

2 Touch the [OUTPUT] key.

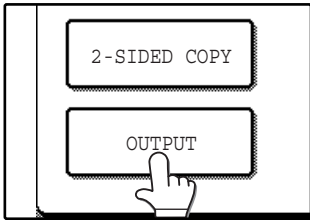

3 Touch the [STAPLE SORT] key.

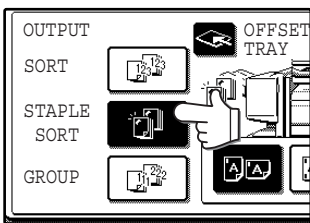

When the [STAPLE SORT] key is selected, the offset tray is automatically selected. Output to the center tray is not possible.

4 Select the staple position.

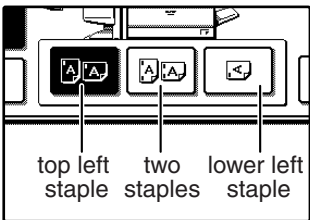

Select top left staple, two staples, or lower left staple as appropriate for the original. For one upper left staple when the original is a size such as 11" x 17" or 8-1/2" x 14" (A3 or B4) in the portrait orientation, select the lower left staple (⏏).

5 Touch the [OK] key.

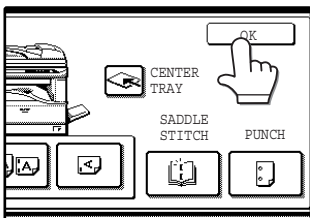

6 Select the number of copies and other copy settings, and touch the [START] key (⏏).

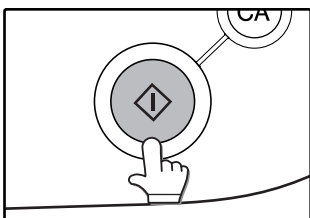

7 Using the RSPF

Copying begins after all pages are scanned.

Using the document glass

Place the next page on the document glass and press the [START] key (⏏). Repeat until all pages have been scanned and then touch the [READ END] key on the panel.

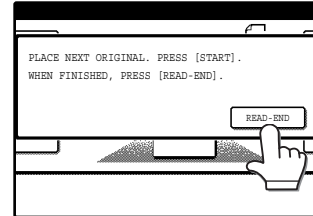

If the memory becomes full while the pages are being scanned, "MEMORY IS FULL. PRESS [START] TO BEGIN COPYING OR [CA] TO CANCEL." will appear in the display. To copy only the pages that have been scanned to that point, press the [START] key (⏏). To cancel the job and clear the scanned pages from memory, press the [CLEAR ALL] key (⏏).



To increase the number of pages that can be scanned into memory, increase the memory allocation in the key operator programs or install more memory. (See "Key operator's guide".)

REPLACING THE STAPLE CARTRIDGE AND REMOVING STAPLE JAMS

A message will appear in the display when the staple cartridge needs replacement or a staple jam occurs. Follow the procedures below to replace the cartridge or remove the jam.

■ Replacing the staple cartridge

1 Open the front cover.

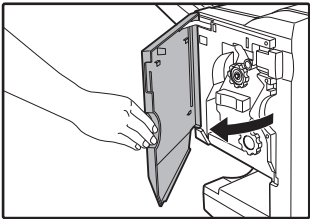

2 Pull the stapler section toward you.

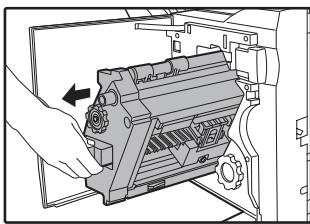

3 Rotate roller rotating knob A in the direction of the arrow to move the staple unit all the way forward.

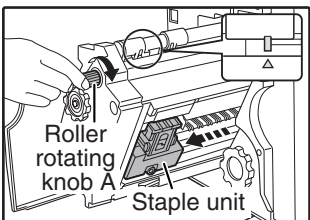

Rotate the roller rotating knob A until the triangle mark and indicator are aligned as shown in the illustration.

4 Remove the empty staple box.

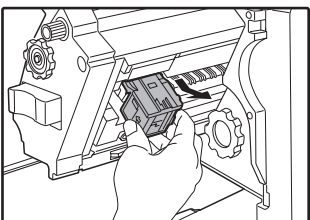

5 Remove the empty staple cartridge.

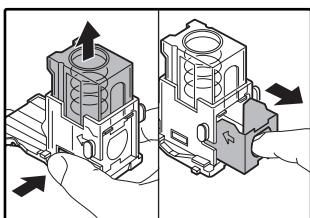

Press the lock button to release the lock on the staple box cover and remove the staple cartridge.



The staple cartridge cannot be removed if staples remain in it.

6 Install the new staple cartridge in the staple box.

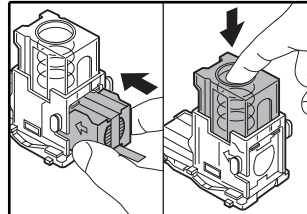

Insert the staple cartridge into the staple box and then press down on the staple box cover to lock the staple cartridge.



- Do not remove the seal that holds the staples before installing the staple cartridge in the staple box.
- Make sure that the new staple cartridge is locked securely in the staple box. Press down on the staple box cover until you hear a "click" indicating that the staple cartridge is locked.

7 Pull the seal that holds the staples straight out.

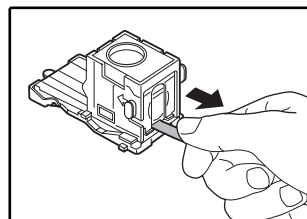

8 Push in the staple box.

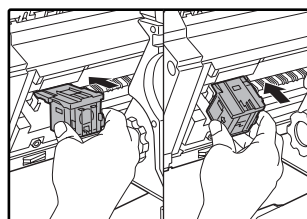

Push until you hear a "click".

9 Push in the stapler section.

10 Close the front cover.



Make a test print or copy in staple sort mode to verify that stapling takes place correctly.

■ Removing a staple jam

- 1 Press the detach button and separate the saddle stitch finisher from the machine.

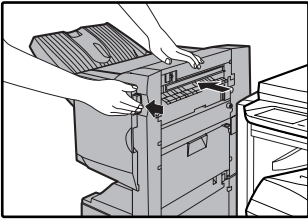

- ⚠ Caution** The saddle stitch finisher and the machine are connected at the rear. Exercise caution when pulling them apart.

- 2 Open the front cover.

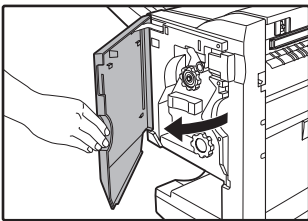

- 3 Rotate roller rotating knob C until the blue indicator appears as shown below.

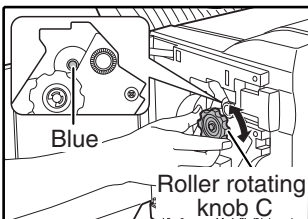

- 4 Remove the paper from the stapler compiler.

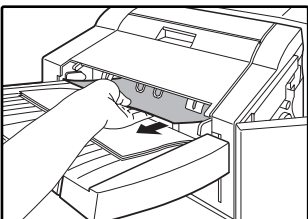

- 5 Open the saddle stitch section cover.

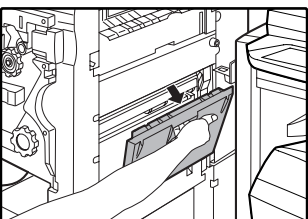

- 6 Remove any misfed paper.

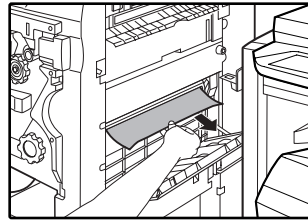

Remove the paper gently without tearing it.

- 7 Close the saddle stitch section cover.

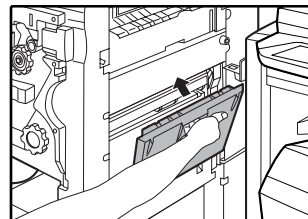

- 8 Pull the stapler section forward.

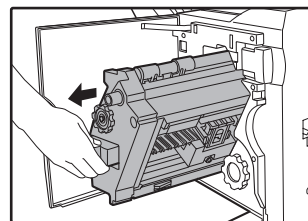

- 9 Rotate roller rotating knob A in the direction of the arrow to move the staple unit all the way forward.

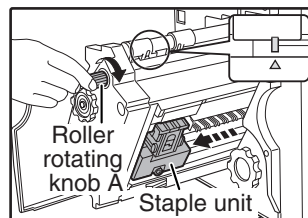

Rotate the roller rotating knob A until the triangle mark and indicator are aligned as shown in the illustration.

- 10 Remove the staple box.

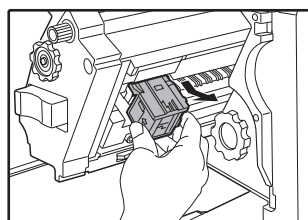

11 Raise the lever on the front edge of the staple box.

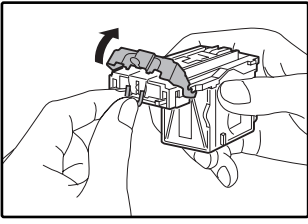

If the leading staple is bent, be sure to cut it off. If a bent staple is used for stapling, a staple jam will result.

12 Replace the front edge lever.

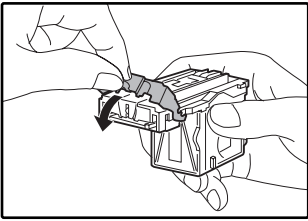

13 Push in the staple box.

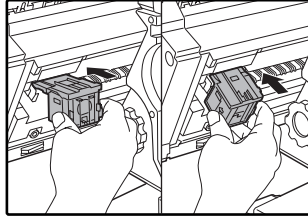

Push the staple box all the way in until you hear a "click".

14 Push in the staple unit.

15 Close the front cover.

16 Push the saddle stitch finisher back onto the machine.

! Caution Print a test job in staple sort mode to verify that stapling takes place correctly.

Discarding punch waste (when a punch unit is installed)

1 Press the detach button and separate the saddle stitch finisher from the machine.

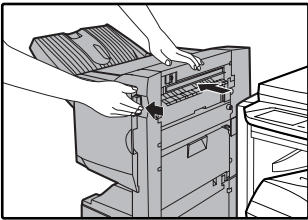

! Caution The saddle stitch finisher and the machine are connected at the rear. Exercise caution when pulling them apart.

2 Gently pull the punch waste receptacle forward and discard the punch waste.

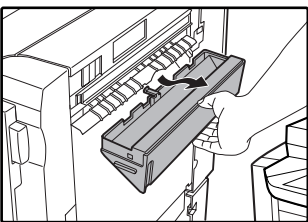

Empty the punch waste receptacle into a garbage bag or other container, taking care not to let punch waste scatter.

3 Replace the punch waste receptacle.

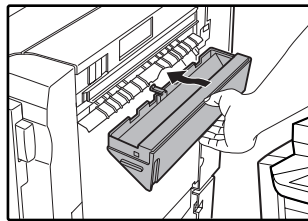

4 Push the saddle stitch finisher back onto the machine.

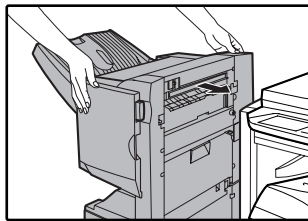

REMOVING PAPER MISFEEDS

When a paper misfeed occurs during copying, a message and picture will appear in the display of the operation panel as shown below and copying will automatically stop. Follow the procedures below to remove the misfeed.

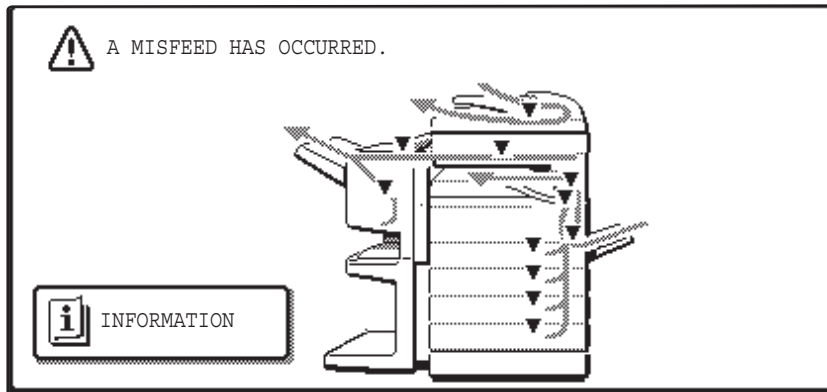

Note When a misfeed occurs, you can touch the [INFORMATION] key to display brief instructions for removing the misfeed.

■ Misfeed in the relay path

- 1** Grasp the hand hold on the center cover and open the cover.

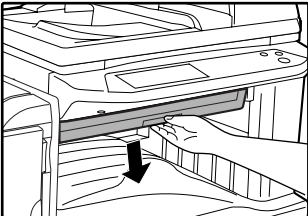

- 2** Remove the misfed paper from the conveyor unit.

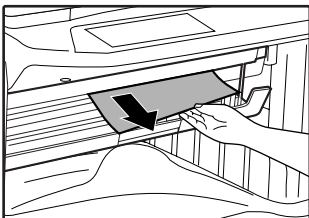

Remove the paper slowly, taking care not to tear it.

- 3** Close the center cover.

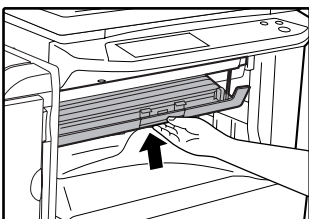

■ Misfeed in the saddle stitch finisher

- 1 Press the detach button and separate the saddle stitch finisher from the machine.**

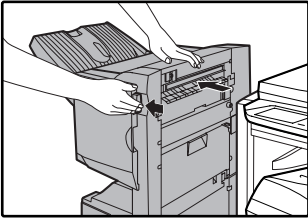

- ! Caution** The saddle stitch finisher and the machine are connected at the rear. Exercise caution when pulling them apart.

- 2 Remove any misfed paper from the machine.**

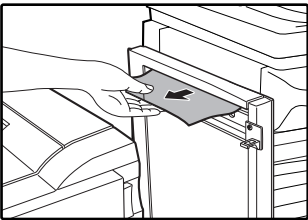

- 3 If there was no misfed paper in step 2, pull roller rotating knob B on the punch unit toward you and rotate it. (Only when an optional punch unit is installed.)**

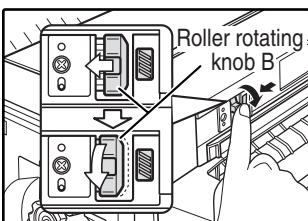

Rotating roller rotating knob B releases the caught paper.

- 4 Open the top cover.**

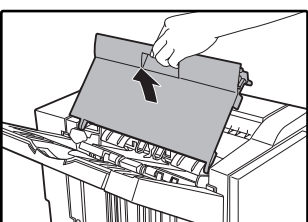

- 5 Remove the misfed paper.**

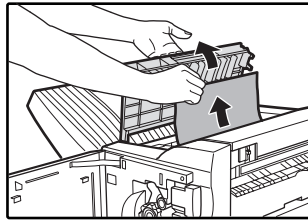

Remove the paper gently, taking care not to tear it.

- 6 Close the top cover.**

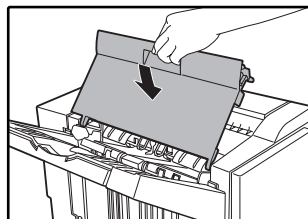

- 7 Remove any misfed paper from the stapler compiler.**

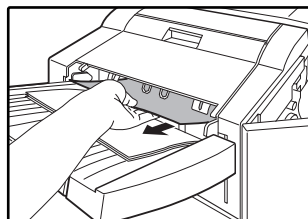

Remove the paper gently, taking care not to tear it.

- 8 Open the cover of the saddle stitch section.**

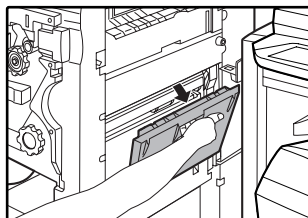

- 9 Remove the misfed paper.**

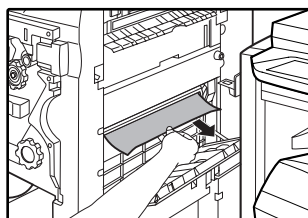

Remove the paper gently, taking care not to tear it.

10 Open the front cover.

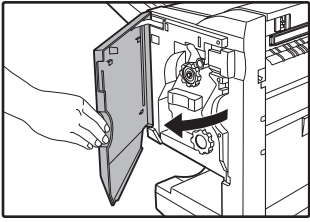

15 Push the saddle stitch finisher back onto the machine.

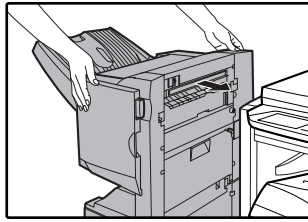

11 Rotate roller rotating knob D in the direction of the arrow.

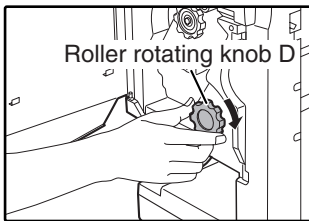

12 Remove any misfed paper from the saddle stitch tray.

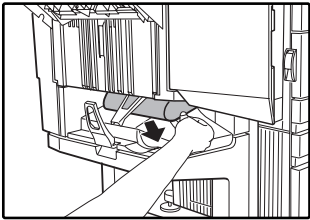

Remove the paper gently, taking care not to tear it.

13 Close the cover of the saddle stitch section.

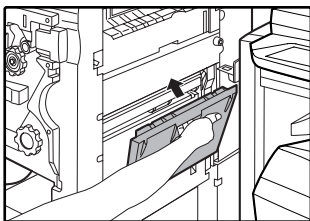

14 Close the front cover.

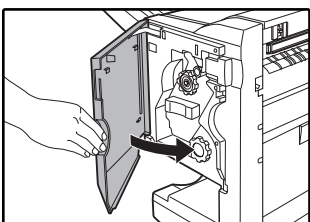

TROUBLESHOOTING (RELATED TO SADDLE STITCH FINISHER)

If you experience difficulty with the saddle stitch finisher, check the following troubleshooting guide before calling for service. Many problems can be resolved by the user.

Problem	Cause and solution	Page
Stapling position is not correct (including saddle stitch)	The staple function is not set correctly for the desired staple position. Check the possible staple positions and adjust appropriately.	3,6,7
The saddle stitch finisher does not operate	The top cover or front cover of the saddle stitch finisher is open. Close all covers.	1
	A message appears instructing you to remove paper from the stapler compiler. Remove all paper that remains in the stapler compiler as explained in step 4 on p.9.	9
Stapling does not take place (including saddle stitch)	A message appears instructing you to check the staple unit. Remove the staple jam.	9
	A message appears informing you that staples are needed. Replace the staple cartridge. Make sure that the staple box has been installed.	8 - 9
	Different widths of paper are mixed together. Stapling of different widths of paper is not possible.	-
	The paper is badly curled and is not stapled when output. Some qualities and types of paper result in bad curling when output. Remove the paper from the tray or the bypass tray, turn it around to reverse the top and bottom, and reload it.	-
Incorrect punch position* ¹	The punch function is not set for the desired punch position. Check the possible punch positions and adjust appropriately.	4
Punching does not take place* ¹	A message appears instructing you to check the punch unit. Discard the punch waste.	10
	Different widths of paper are mixed together. Punching of different widths of paper is not possible.	-
	The paper is badly curled and is not punched when output. Some qualities and types of paper result in bad curling when output. Remove the paper from the tray or the bypass tray, turn it around to reverse the top and bottom, and reload it.	-
"CALL FOR SERVICE. CODE:F1-53." is displayed.	The cable between the machine and the saddle stitch finisher is not connected. Turn off the power of the machine, connect the cable on the back of the saddle stitch finisher to the connector on the machine, and then turn on the machine power.	-

*1 When an optional punch unit is installed.

USING THE KEY OPERATOR PROGRAMS

When the saddle stitch finisher is installed on the multifunction machine, the key operator programs indicated below are added or changed. For information on "USING THE KEY OPERATOR PROGRAMS", see page 2 of the "Key operator's guide" that comes with the machine.

■ Added programs

The following two programs are added to "DEVICE CONTROL" (page 12 of the "Key operator's guide"):

Disabling of finisher

This program is used to prohibit use of the saddle stitch finisher. The program is also used if the finisher fails. When use of the finisher is prohibited, the staple function, saddle stitch function, punch function, and output destination are grayed out.

Saddle stitch position adjust

This program is used to adjust the stapling position (folding position) when the saddle stitch function is used. The position can be shifted within a range of ± 3.0 mm from the base position in increments of 0.1 mm. When "AUTOMATIC SADDLE STITCH" is disabled and "SADDLE STITCH" is selected in "OUTPUT", the display does not change to the pamphlet setting screen.

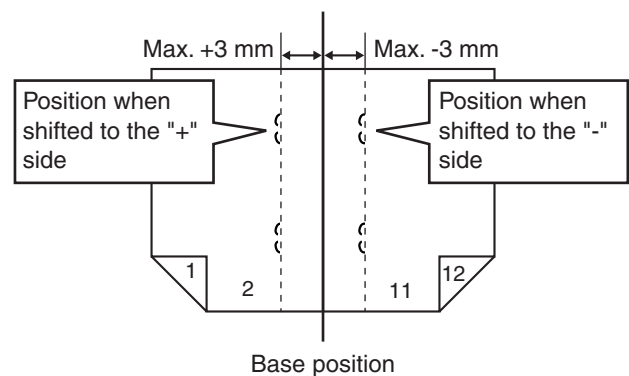

■ Changed programs

The "OUTPUT TRAYS" and "INITIAL STATUS SETTINGS" programs are changed when the saddle stitch finisher is installed.

Output trays

A combination of output destinations can be selected for copying, printing, and fax in "OUTPUT TRAYS" in "DEVICE CONTROL". When the saddle stitch finisher is installed, the combinations that can be selected are as shown at right.

Selections	Description
PATTERN 1	Copying: Offset tray Printing: Center tray Fax: Center tray
PATTERN 2	Copying: Center tray Printing: Offset tray Fax: Center tray
PATTERN 3	Copying: Center tray Printing: Offset tray Fax: Offset tray
PATTERN 4	Copying: Offset tray Printing: Center tray Fax: Offset tray



If the machine does not have the fax function, "PATTERN 3" and "PATTERN 4" do not appear and the tray positions in "PATTERN 1" and "PATTERN 2" change.

Initial status settings

The stapling position when the copy settings are returned to the default settings can be selected. Select the stapling position for the staple sort function in "OUTPUT" in "INITIAL STATUS SETTINGS" of the "COPY FUNCTION SETTINGS".

SHARP[®]
SHARP CORPORATION